

TE100+TE101

ALUGRILL100

Profili per serrande e negozi in alluminio estruso

Profiles for shutters and shops in extruded aluminum

Profilés pour volets et magasins en aluminium extrudé

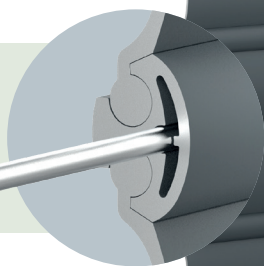

SP4120

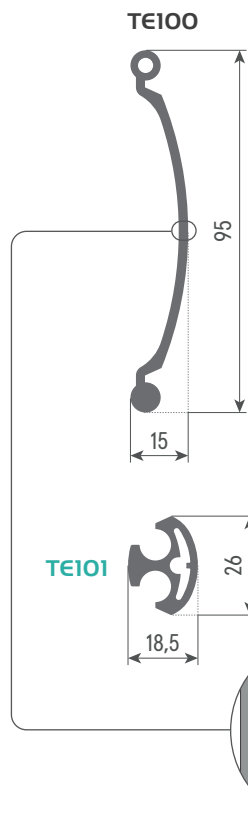

Caratteristiche

Features / Caractéristiques

Dimensioni / Dimensions / Dimensions	mm	15 x 95
Peso al mq / Weight for sqm / Poids au m ²	kg	~ 11
Profili per mt di altezza / Profiles for meter in height / Profils pour un mètre de hauteur	n	13

Asolatura / Hole / Trou

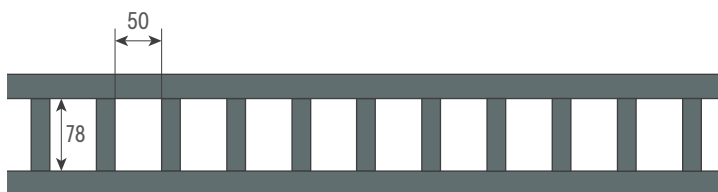

ALLUMINIO (SPESSORE MINIMO) / ALUMINUM (MINIMUM THICKNESS) / ALUMINIUM (EPAISSEUR MINIMALE)	mm	2,5
PRE-TRATTAMENTO DI OSSIDAZIONE FLASH ESENTE CROMO SECONDO NORME QUALICOAT SEASIDE E QUALANOD FLASH OXIDATION PRE-TREATMENT PROCESS ACCORDING TO QUALICOAT SEASIDE AND QUALANOD PRÉTRAITEMENT D'OXYDATION "FLASH" SELON LES NORMES QUALICOAT SEASIDE ET QUALANOD	µm	~ 5
VERNICE / PAINT / PEINTURE	µm	~ 80/100

Imballaggio e codici

Packaging and codes / Emballage et codes

Profilo / Profile / Profil	Tipologia / Typology / Typologie	n	L	📦	Codice / Art / Reference	
					TE100 580	TE101 580
TE100 (perforato / perforated / perfore)	☰ Profili / Profiles/ Profils	5,8 mtl			TE100 580	**
TE100 (cieco / without holes / plein)	☰ Profili / Profiles/ Profils	5,8 mtl			TE100 58001	**
TE100	☉ Teli / Shutter / Volet				TE100 222	**
TE101	☰ Profili / Profiles/ Profils	5,8 mtl			TE101 580	**

GUIDE / GUIDES / COULISSES

GUARNIZIONI / GASKET / JOINT

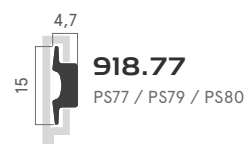
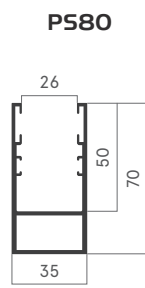
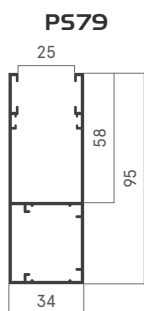
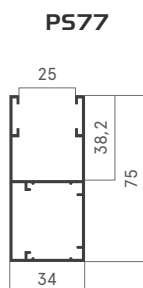

TERMINALI / END SLATS / LAME FINALES

ACCESSORI TERMINALE / END SLATS ACCESSORIES / ACCESSOIRES LAME FINALES

TM78

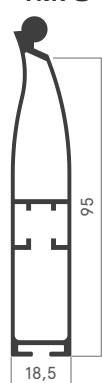

914.170
PIATTINA PER SERRATURA IN ACCIAIO
STEEL BAR FOR LOCK
PROFILE EN ACIER POUR SERRURE

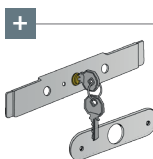

905.30
SERRATURA CON CILINDRO
LOCK WITH CYLINDER
SERRURE AVEC CYLINDRE

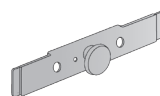

905.31
SERRATURA CON POMOLO
LOCK WITH KNOB
SERRURE AVEC BOUTON

GUARNIZIONI / GASKET / JOINT

OPTIONAL / OPTIONAL / OPTIONNEL

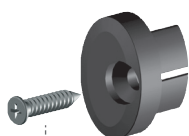
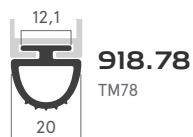

909.100
TAPPO ANTIUSURA E ANTIRUMORE
ANTI-WEARING AND ANTINOISE PLUG
BOUCHON ANTI-USURE ET ANTI-BRUIT

SP4301
VITE / SCREW / VIS

Ø4mm



SP4120
BARRA ANTITAGLIO
ANTI-CUTTING BAR
PROFILI ANTI-COUPÉ

ACCIAIO INOX AISI 306
AISI 306 stainless steel / Acier inoxydable AISI 306

Installazione

Installation / Installation

H	Ø 100 mm	
	D	D
mm	mm	
1200	205	190
1400		195
1600		205
1800	250	215
2000		230
2200		240
2400	300	250
2600		255
2800		265
3000		275

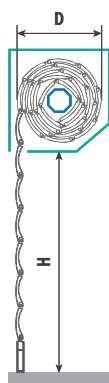

Dimensione massima / Maximum size / Taille maximale

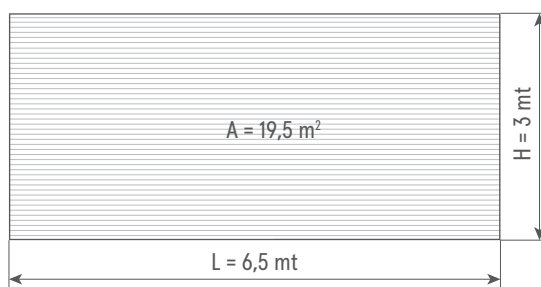

CODICI COLORI SECONDO TINTA RAL / COLOR CODES ACCORDING TO RAL COLOR / CODES COULEUR SELON LA COULEUR RAL



Per garantire sempre lo stesso colore dei profili è preferibile indicare il codice della polvere scelta per la verniciatura.

It is advisable to indicate the code of the powder chosen for the coating to always guarantee the same color of the profiles.
Pour garantir toujours la même couleur des profils il est préférable d'indiquer le code de la poudre choisie pour le revêtement.

Polveri utilizzate / Powders used / Poudres utilisées: AKZONOBEL, AXALTA - (Su richiesta in classe 1 e 2 / On request class 1 and 2 / Sur requête class 1 et 2)