

TE78

ALUWIND78



ABBINABILE CON
COMBINABLE WITH / COMBINABLE AVEC
T77 - TS77 - TE77

Profilo per garage con fori e plexiglass in alluminio estruso

Extruded aluminum profile with holes and plexiglass

Profilé pour portes garage avec trous et plexiglas en aluminium extrudé

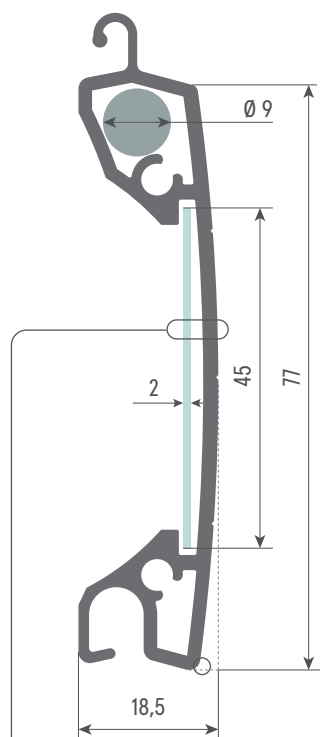
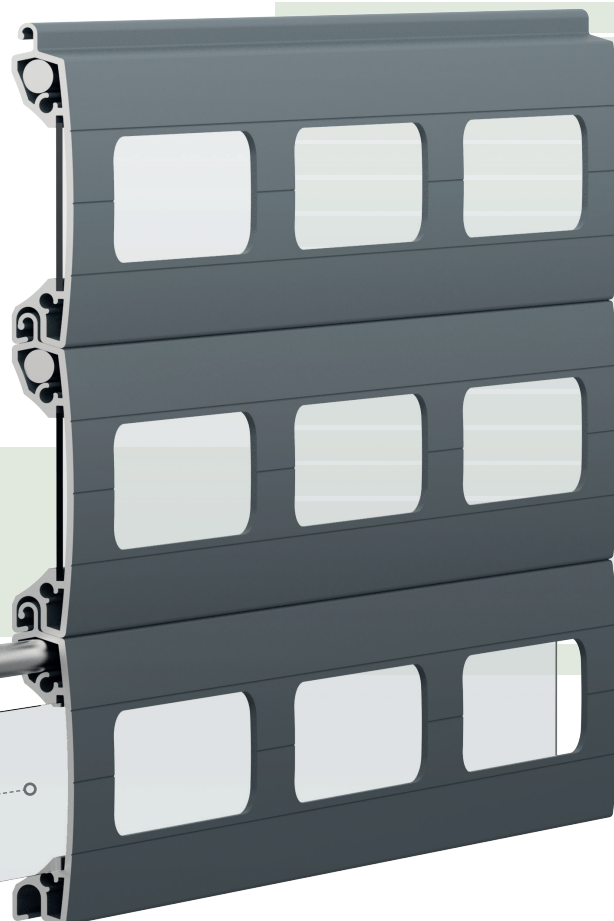

SP4121

918.79

Caratteristiche

Features / Caractéristiques

Dimensioni / Dimensions / Dimensions	mm	18,5 x 77
Peso al mq / Weight for sqm / Poids au m ²	kg	~ 10
Profili per mt di altezza / Profiles for meter in height / Profils pour un mètre de hauteur	n	12

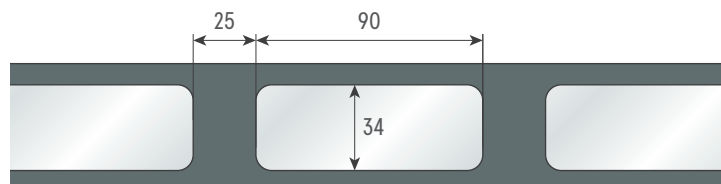

Asolatura / Hole / Trou

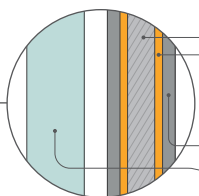

ALLUMINIO (SPESSORE MINIMO) / ALUMINUM (MINIMUM THICKNESS) / ALUMINIUM (ÉPAISSEUR MINIMALE)	mm	1,1
PRE-TRATTAMENTO DI OSSIDAZIONE FLASH ESENTE CROMO SECONDO NORME QUALICOAT SEASIDE E QUALANOD FLASH OXIDATION PRE-TREATMENT PROCESS ACCORDING TO QUALICOAT SEASIDE AND QUALANOD PRÉTRAITEMENT D'OXIDATION "FLASH" SELON LES NORMES QUALICOAT SEASIDE ET QUALANOD	µm	~ 5
VERNICE / PAINT / PEINTURE	µm	~ 80/100
INSERTO IN PLEXIGLASS MAKROLON CON PROTEZIONE UV MAKROLON PLEXIGLASS INSERT WITH UV PROTECTION / INSERT EN PLEXIGLAS MAKROLON AVEC PROTECTION UV	mm	2

Imballaggio e codici

Packaging and codes / Emballage et codes

Profilo / Profile / Profil	Tipologia / Typology / Typologie	n	L	Codice / Art / Reference	Colore / Color / Couleur
TE78 (perforato / perforated / perfore)	≡ Profili / Profiles / Profils			TE78 650	**
TE78 (cieco / without holes / plein)	≡ Profili / Profiles / Profils			TE78 6501	**
TE78 (perforato / perforated / perfore)	⊙ Teli / Shutter / Volet			TE78 222	**

GUIDE / GUIDES / COULISSES

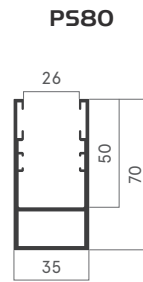
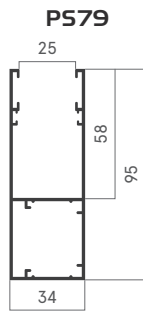
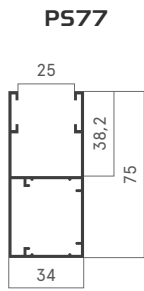

GUARNIZIONI / GASKET / JOINT

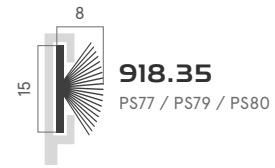
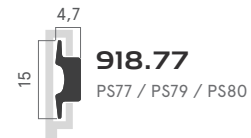

TERMINALI / END SLATS / LAME FINALES

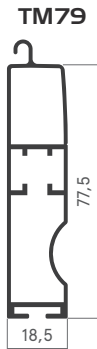
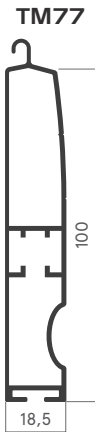

ACCESSORI TERMINALE / END SLATS ACCESSORIES / ACCESSOIRES LAME FINALES



914.170
PIATTINA PER SERRATURA IN ACCIAIO
STEEL BAR FOR LOCK
PROFILE EN ACIER POUR SERRURE

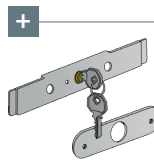

905.30
SERRATURA CON CILINDRO
LOCK WITH CYLINDER
SERRURE AVEC CYLINDRE

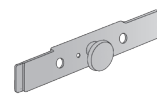

905.31
SERRATURA CON POMOLO
LOCK WITH KNOB
SERRURE AVEC BOUTON

GUARNIZIONI / GASKET / JOINT

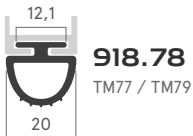

918.78
TM77 / TM79

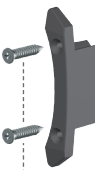

909.78
TAPPO ANTIUSURA E ANTIRUMORE
ANTI-WEARING AND ANTI-NOISE PLUG
BOUCHON ANTI-USURE ET ANTI-BRUIT

SP4301
VITE / SCREW / VIS

OPTIONAL / OPTIONAL / OPTIONNEL

Ø9mm



SP4121
BARRA ANTITAGLIO
ANTI-CUTTING BAR
PROFIL ANTI-COUPÉ

ACCIAIO INOX AISI 306
AISI 306 stainless steel / Acier inoxydable AISI 306

COMPONENTI / COMPONENTS / COMPOSANTS



918.79
LAMA IN MAKROLON UV
BAR IN MAKROLON UV
LAME MAKROLON UV



Resistenza a rotture, agenti atmosferici e trasparenza garantita 10 anni

Resistance to breakage, atmospheric agents and transparency guaranteed for 10 years
Résistance à la rupture, aux agents atmosphériques et transparence garantie 10 ans

H	Ø 80 mm		Ø 100 mm	
	D	D	D	D
mm	mm	mm	mm	mm
1600	250	220	250	230
1800		230		240
2000		235		245
2200	300	245	300	255
2400		255		260
2600		265		270
2800		275		280
3000		290		300
3200		300		305

Installazione

Installation / Installation

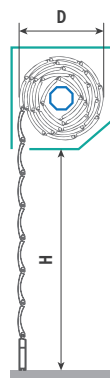

Dimensione massima / Maximum size / Taille maximale

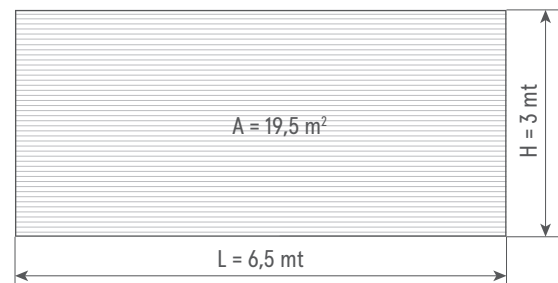

CODICI COLORI SECONDO TINTA RAL / COLOR CODES ACCORDING TO RAL COLOR / CODES COULEUR SELON LA COULEUR RAL



Per garantire sempre lo stesso colore dei profili è preferibile indicare il codice della polvere scelta per la verniciatura.

It is advisable to indicate the code of the powder chosen for the coating to always guarantee the same color of the profiles.

Pour garantir toujours la même couleur des profils il est préférable d'indiquer le code de la poudre choisie pour le revêtement.

Polveri utilizzate / Powders used / Poudres utilisées: AKZONOBEL, AXALTA - (Su richiesta in classe 1 e 2 / On request class 1 and 2 / Sur requête class 1 et 2)